

# LOT 308

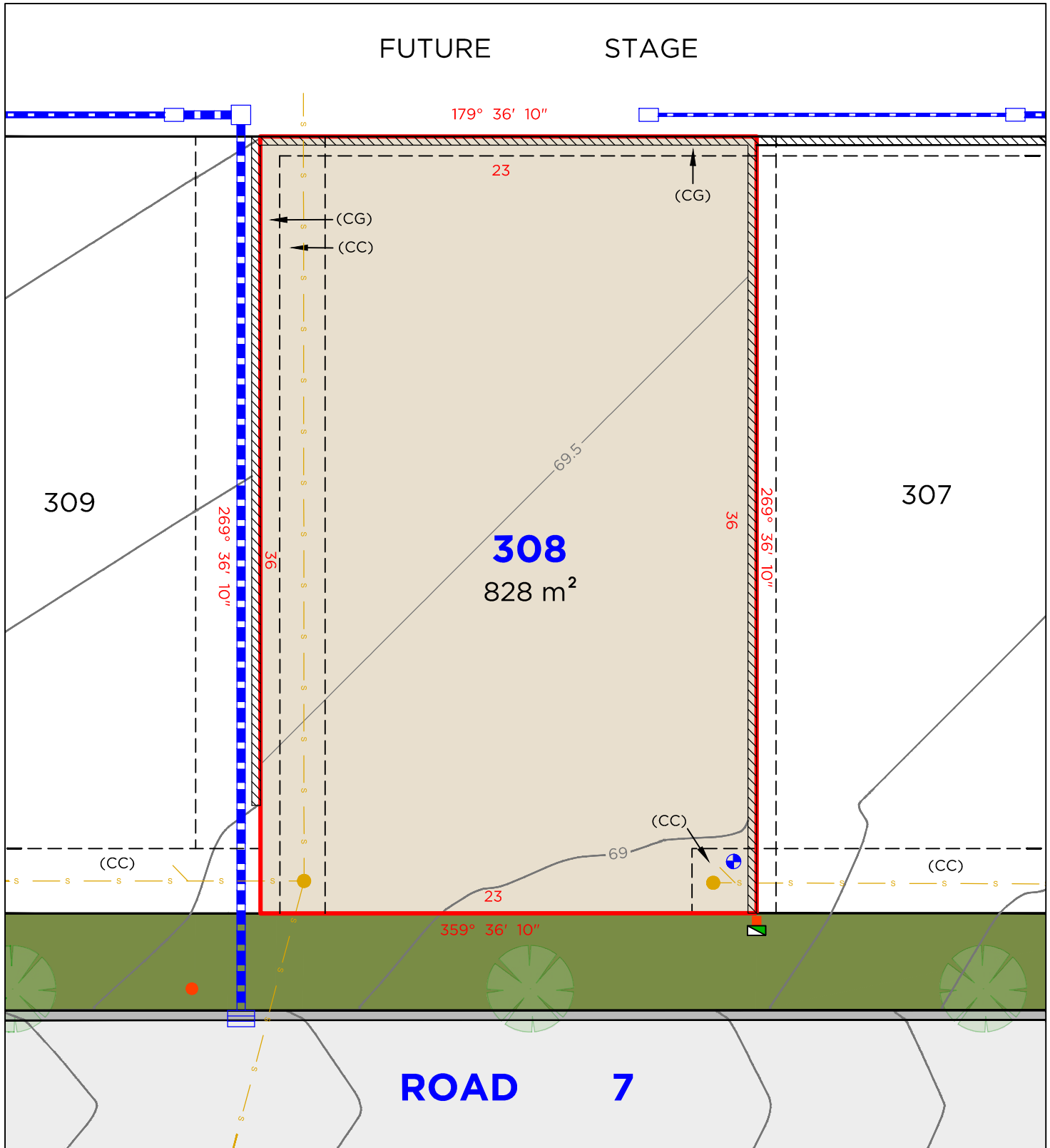

## LEGEND

	BOUNDARY LINE		TELSTRA / NBN PIT
	ADJACENT BOUNDARY		ELECTRICAL PILLAR
	EASEMENT		LIGHT POLE
	SEWER		SEWER MAN HOLE
	STORMWATER		DRAINAGE PIT
	RETAINING WALL		KERB INLET PIT
	WATER METER		STOP VALVE
	HYDRANT		

## EASEMENTS

- (CC) EASEMENT TO DRAIN SEWAGE 3 WIDE
- (CG) EASEMENT FOR SUPPOT 0.9 WIDE

## DISCLAIMER

1. THIS PLAN HAS BEEN COMPILED FROM DESIGN PLANS AT THE SCALE/S STATED. IT IS RECOMMENDED THAT A SURVEY IS UNDERTAKEN PRIOR TO THE PREPARATION OF CONSTRUCTION DRAWINGS. THE PLAN IS SUITABLE FOR DESIGN ONLY & MAY NOT BE SUITABLE FOR ANY OTHER PURPOSE OR FOR USE AT ANY OTHER SCALES/S.
2. THE BOUNDARIES & SERVICES SHOWN ARE APPROXIMATE ONLY. FURTHER SURVEY WILL BE REQUIRED IF CONSTRUCTION IS TO TAKE PLACE ON OR ADJACENT TO THE BOUNDARIES.

**NOTE** • ANTICIPATED LOT CLASSIFICATION IS H2

**DELFS LASCELLES**  
CONSULTING SURVEYORS

**THE FAIRWAYS**  
SINGLETON

# LOT 309

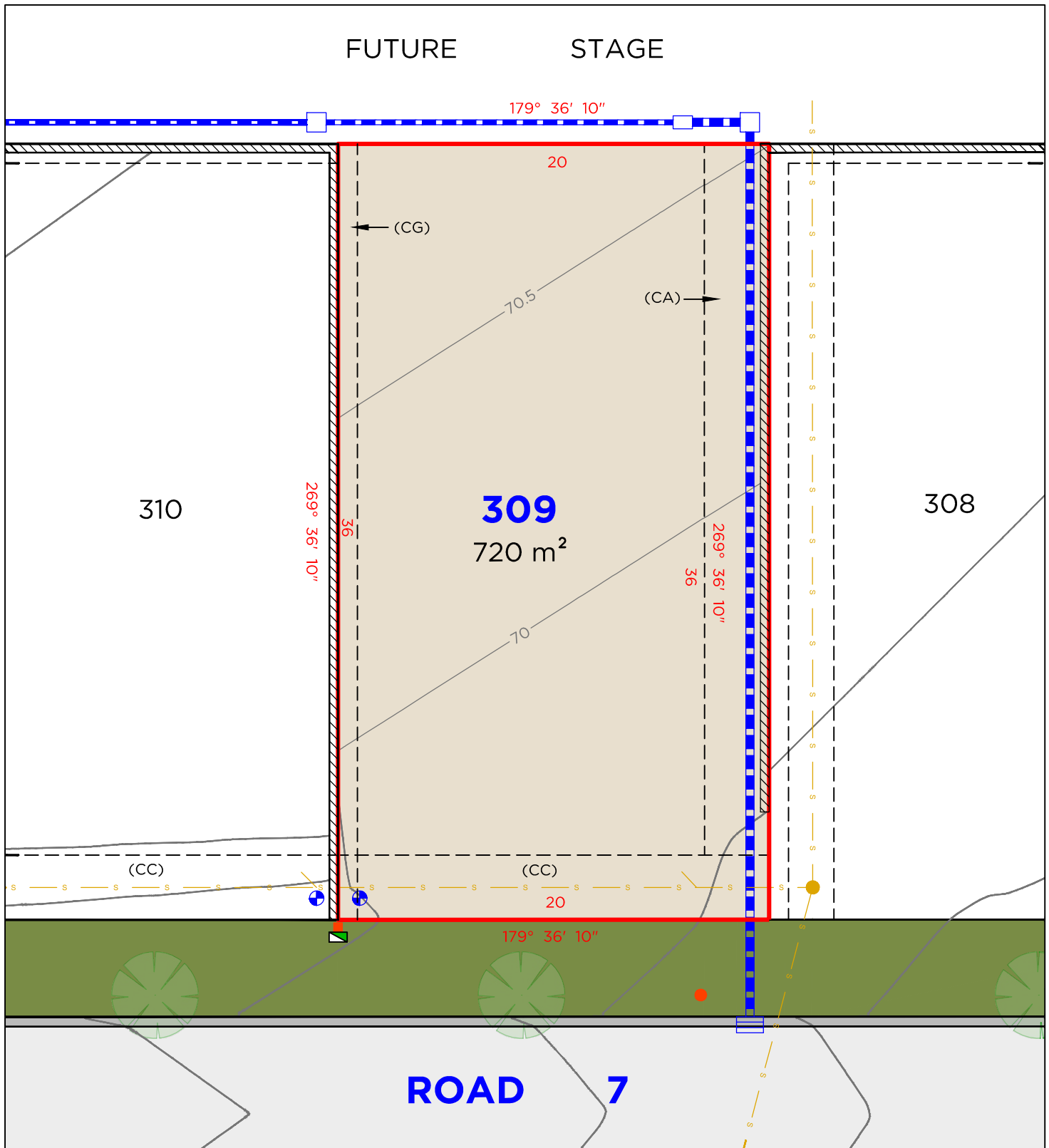

## LEGEND

	BOUNDARY LINE		TELSTRA / NBN PIT
	ADJACENT BOUNDARY		ELECTRICAL PILLAR
	EASEMENT		LIGHT POLE
	SEWER		SEWER MAN HOLE
	STORMWATER		DRAINAGE PIT
	RETAINING WALL		KERB INLET PIT
	WATER METER		STOP VALVE
	HYDRANT		

## EASEMENTS

- (CA) EASEMENT TO DRAIN WATER 3 WIDE
- (CC) EASEMENT TO DRAIN SEWAGE 3 WIDE
- (CG) EASEMENT FOR SUPPOT 0.9 WIDE

## DISCLAIMER

1. THIS PLAN HAS BEEN COMPILED FROM DESIGN PLANS AT THE SCALE/S STATED. IT IS RECOMMENDED THAT A SURVEY IS UNDERTAKEN PRIOR TO THE PREPARATION OF CONSTRUCTION DRAWINGS. THE PLAN IS SUITABLE FOR DESIGN ONLY & MAY NOT BE SUITABLE FOR ANY OTHER PURPOSE OR FOR USE AT ANY OTHER SCALES/S.
2. THE BOUNDARIES & SERVICES SHOWN ARE APPROXIMATE ONLY. FURTHER SURVEY WILL BE REQUIRED IF CONSTRUCTION IS TO TAKE PLACE ON OR ADJACENT TO THE BOUNDARIES.

**NOTE** • ANTICIPATED LOT CLASSIFICATION IS H2

**DELFS LASCELLES**  
CONSULTING SURVEYORS

**THE FAIRWAYS**  
SINGLETON

# LOT 310

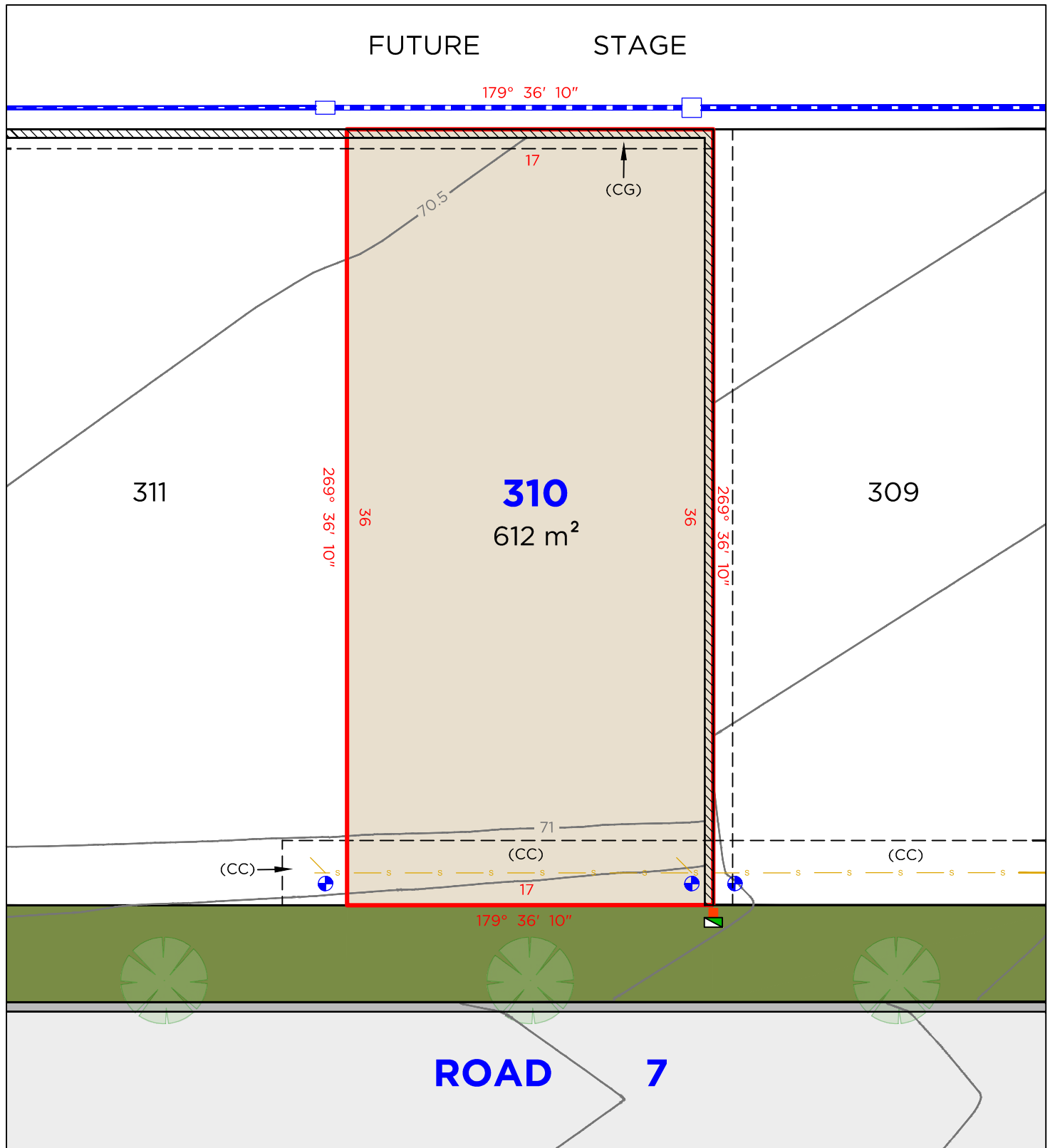

## LEGEND

- BOUNDARY LINE
- ADJACENT BOUNDARY
- EASEMENT
- SEWER
- STORMWATER
- RETAINING WALL
- WATER METER
- HYDRANT

- TELSTRA / NBN PIT
- ELECTRICAL PILLAR
- LIGHT POLE
- SEWER MAN HOLE
- DRAINAGE PIT
- KERB INLET PIT
- STOP VALVE

## EASEMENTS

- (CC) EASEMENT TO DRAIN SEWAGE 3 WIDE
- (CG) EASEMENT FOR SUPPOT 0.9 WIDE

## DISCLAIMER

1. THIS PLAN HAS BEEN COMPILED FROM DESIGN PLANS AT THE SCALE/S STATED. IT IS RECOMMENDED THAT A SURVEY IS UNDERTAKEN PRIOR TO THE PREPARATION OF CONSTRUCTION DRAWINGS. THE PLAN IS SUITABLE FOR DESIGN ONLY & MAY NOT BE SUITABLE FOR ANY OTHER PURPOSE OR FOR USE AT ANY OTHER SCALES/S.
2. THE BOUNDARIES & SERVICES SHOWN ARE APPROXIMATE ONLY. FURTHER SURVEY WILL BE REQUIRED IF CONSTRUCTION IS TO TAKE PLACE ON OR ADJACENT TO THE BOUNDARIES.

**NOTE** • ANTICIPATED LOT CLASSIFICATION IS H2

**DELFS LASCELLES**  
CONSULTING SURVEYORS

**THE FAIRWAYS**  
SINGLETON

# LOT 311

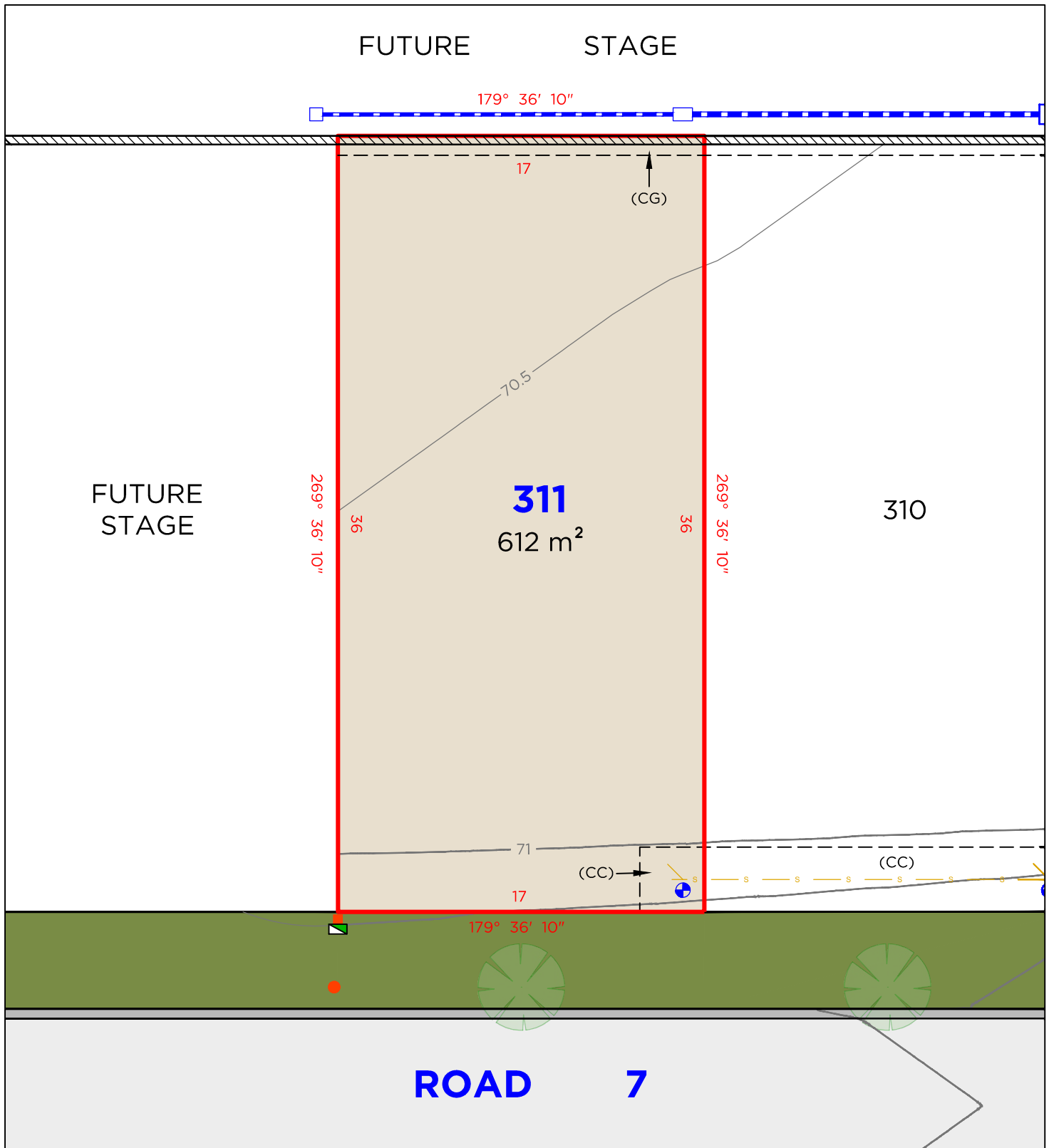

## LEGEND

- BOUNDARY LINE
- ADJACENT BOUNDARY
- EASEMENT
- s SEWER
- STORMWATER
- RETAINING WALL
- ⊕ WATER METER
- ⊗ HYDRANT

- TELSTRA / NBN PIT
- ELECTRICAL PILLAR
- LIGHT POLE
- SEWER MAN HOLE
- DRAINAGE PIT
- ▢ KERB INLET PIT
- ⊙ STOP VALVE

## EASEMENTS

- (CC) EASEMENT TO DRAIN SEWAGE 3 WIDE
- (CG) EASEMENT FOR SUPPOT 0.9 WIDE

## DISCLAIMER

1. THIS PLAN HAS BEEN COMPILED FROM DESIGN PLANS AT THE SCALE/S STATED. IT IS RECOMMENDED THAT A SURVEY IS UNDERTAKEN PRIOR TO THE PREPARATION OF CONSTRUCTION DRAWINGS. THE PLAN IS SUITABLE FOR DESIGN ONLY & MAY NOT BE SUITABLE FOR ANY OTHER PURPOSE OR FOR USE AT ANY OTHER SCALES/S.
2. THE BOUNDARIES & SERVICES SHOWN ARE APPROXIMATE ONLY. FURTHER SURVEY WILL BE REQUIRED IF CONSTRUCTION IS TO TAKE PLACE ON OR ADJACENT TO THE BOUNDARIES.

**NOTE** • ANTICIPATED LOT CLASSIFICATION IS H2

**DELFS LASCELLES**  
CONSULTING SURVEYORS

**THE FAIRWAYS**  
SINGLETON

# LOT 312



## ROAD 7

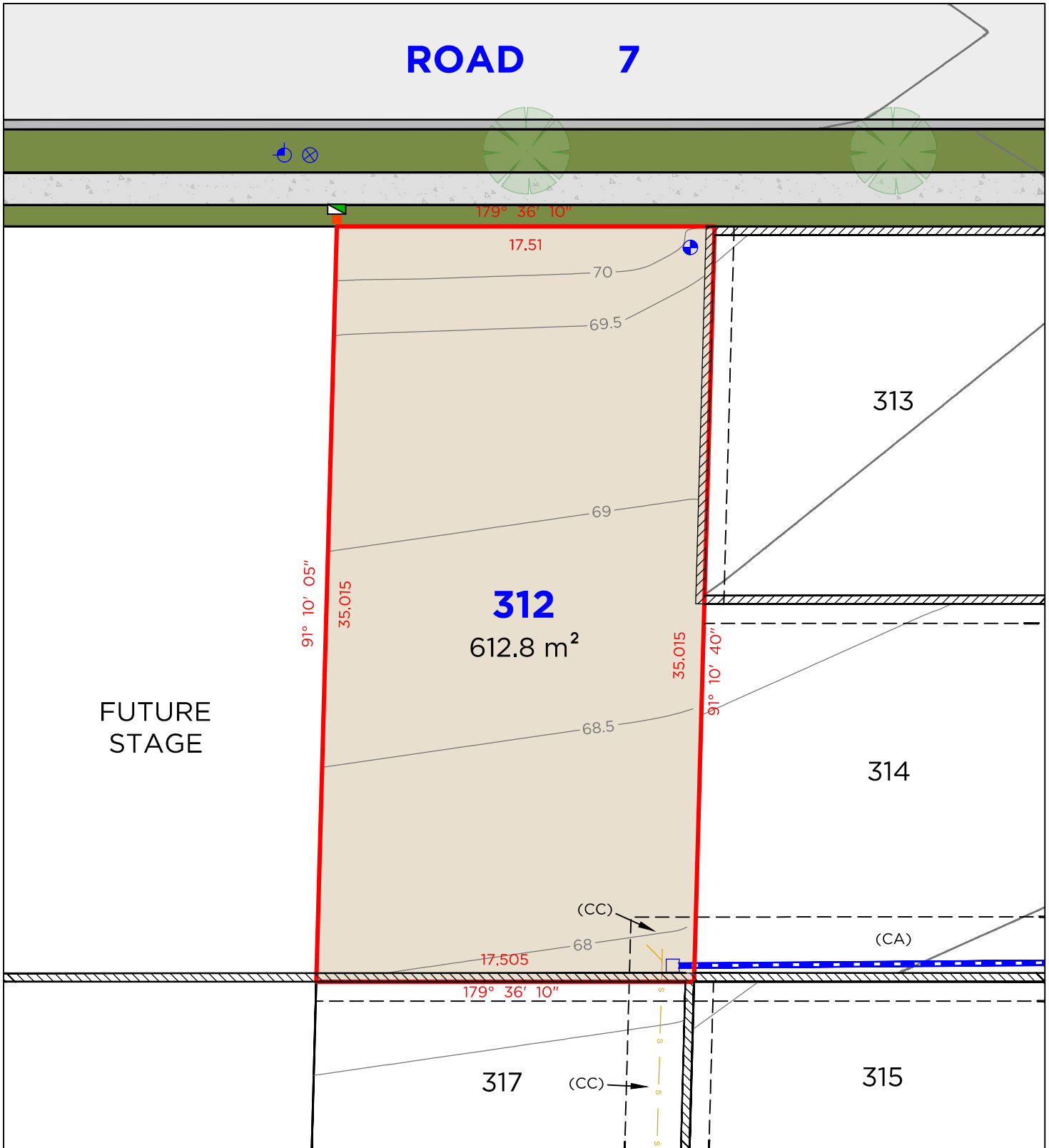

### LEGEND

- BOUNDARY LINE
- ADJACENT BOUNDARY
- EASEMENT
- SEWER
- STORMWATER
- RETAINING WALL
- WATER METER
- HYDRANT

- TELSTRA / NBN PIT
- ELECTRICAL PILLAR
- LIGHT POLE
- SEWER MAN HOLE
- DRAINAGE PIT
- KERB INLET PIT
- STOP VALVE

### EASEMENTS

- (CA) EASEMENT TO DRAIN WATER 3 WIDE
- (CC) EASEMENT TO DRAIN SEWAGE 3 WIDE

### DISCLAIMER

1. THIS PLAN HAS BEEN COMPILED FROM DESIGN PLANS AT THE SCALE/S STATED. IT IS RECOMMENDED THAT A SURVEY IS UNDERTAKEN PRIOR TO THE PREPARATION OF CONSTRUCTION DRAWINGS. THE PLAN IS SUITABLE FOR DESIGN ONLY & MAY NOT BE SUITABLE FOR ANY OTHER PURPOSE OR FOR USE AT ANY OTHER SCALES/S.
2. THE BOUNDARIES & SERVICES SHOWN ARE APPROXIMATE ONLY. FURTHER SURVEY WILL BE REQUIRED IF CONSTRUCTION IS TO TAKE PLACE ON OR ADJACENT TO THE BOUNDARIES.

**NOTE** • ANTICIPATED LOT CLASSIFICATION IS H2

**DELFS LASCELLES**  
CONSULTING SURVEYORS

**THE FAIRWAYS**  
SINGLETON

# LOT 313

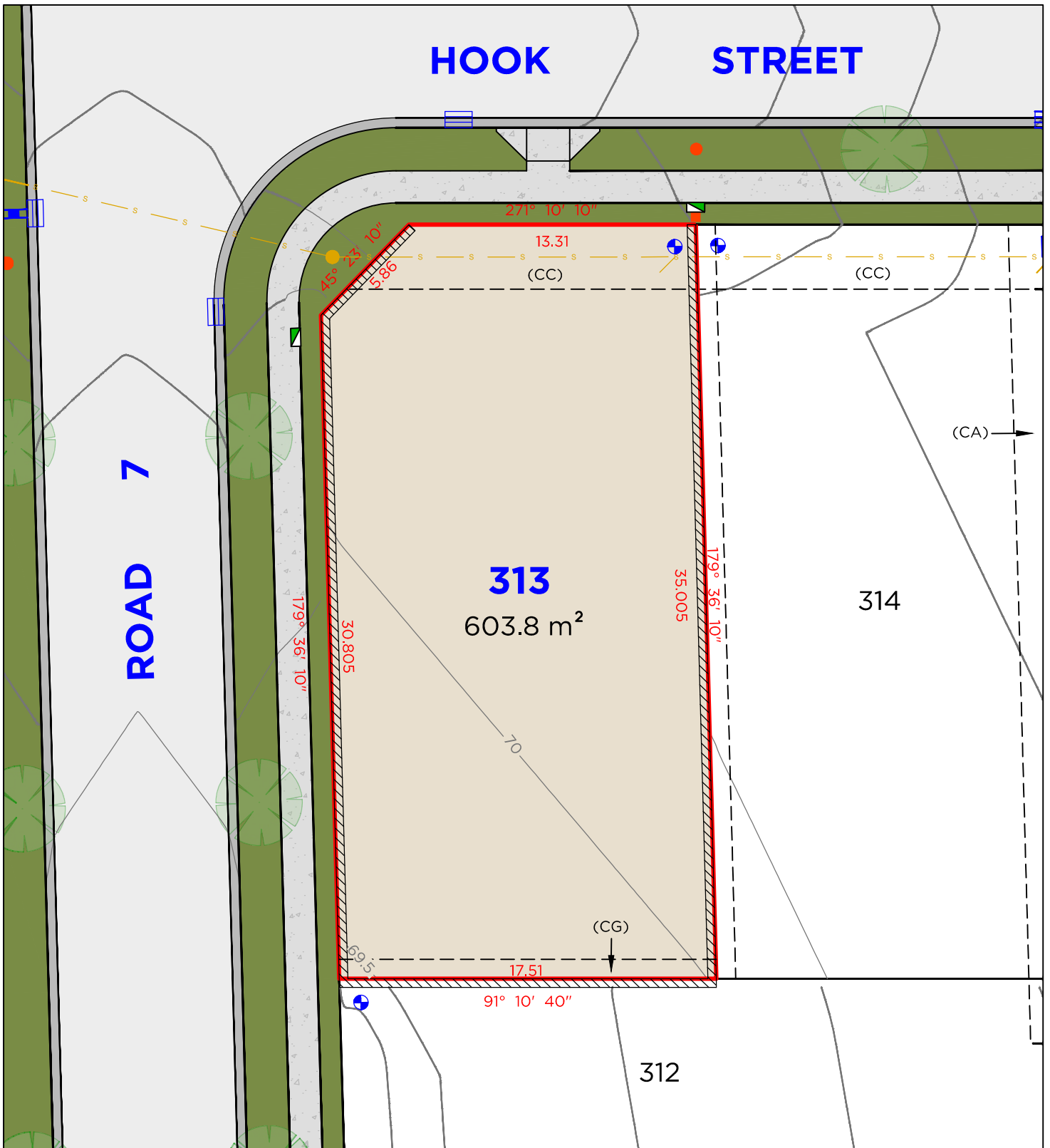

## LEGEND

- BOUNDARY LINE
- ADJACENT BOUNDARY
- EASEMENT
- SEWER
- STORMWATER
- RETAINING WALL
- WATER METER
- HYDRANT

- TELSTRA / NBN PIT
- ELECTRICAL PILLAR
- LIGHT POLE
- SEWER MAN HOLE
- DRAINAGE PIT
- KERB INLET PIT
- STOP VALVE

## EASEMENTS

- (CA) EASEMENT TO DRAIN WATER 3 WIDE
- (CC) EASEMENT TO DRAIN SEWAGE 3 WIDE
- (CG) EASEMENT FOR SUPPOT 0.9 WIDE

## DISCLAIMER

1. THIS PLAN HAS BEEN COMPILED FROM DESIGN PLANS AT THE SCALE/S STATED. IT IS RECOMMENDED THAT A SURVEY IS UNDERTAKEN PRIOR TO THE PREPARATION OF CONSTRUCTION DRAWINGS. THE PLAN IS SUITABLE FOR DESIGN ONLY & MAY NOT BE SUITABLE FOR ANY OTHER PURPOSE OR FOR USE AT ANY OTHER SCALES/S.
2. THE BOUNDARIES & SERVICES SHOWN ARE APPROXIMATE ONLY. FURTHER SURVEY WILL BE REQUIRED IF CONSTRUCTION IS TO TAKE PLACE ON OR ADJACENT TO THE BOUNDARIES.

**NOTE** • ANTICIPATED LOT CLASSIFICATION IS H2

**DELFS LASCELLES**  
CONSULTING SURVEYORS

**THE FAIRWAYS**  
SINGLETON

# LOT 314

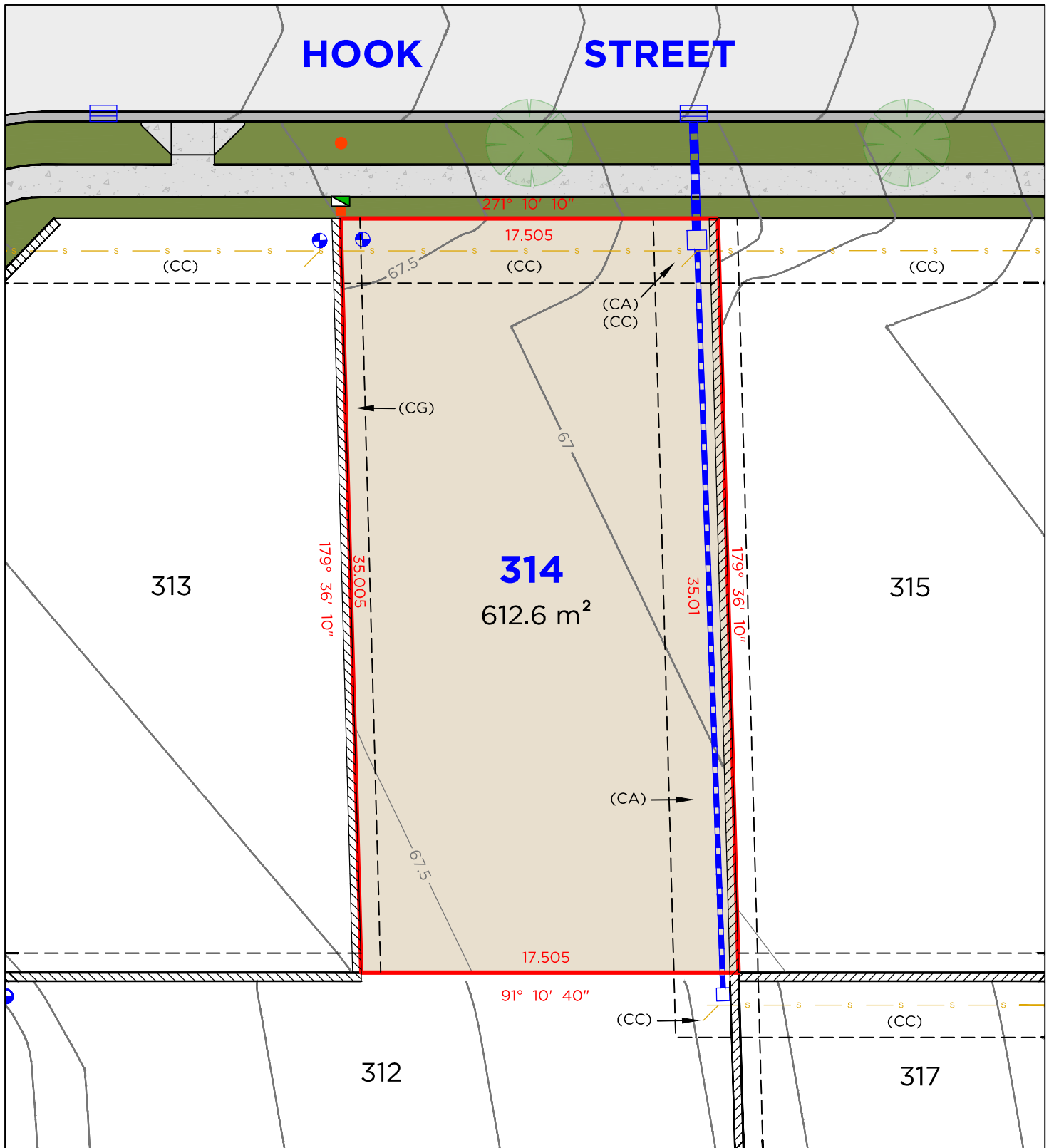

## LEGEND

	BOUNDARY LINE		TELSTRA / NBN PIT
	ADJACENT BOUNDARY		ELECTRICAL PILLAR
	EASEMENT		LIGHT POLE
	SEWER		SEWER MAN HOLE
	STORMWATER		DRAINAGE PIT
	RETAINING WALL		KERB INLET PIT
	WATER METER		STOP VALVE
	HYDRANT		

## EASEMENTS

- (CA) EASEMENT TO DRAIN WATER 3 WIDE
- (CC) EASEMENT TO DRAIN SEWAGE 3 WIDE
- (CG) EASEMENT FOR SUPPOT 0.9 WIDE

## DISCLAIMER

1. THIS PLAN HAS BEEN COMPILED FROM DESIGN PLANS AT THE SCALE/S STATED. IT IS RECOMMENDED THAT A SURVEY IS UNDERTAKEN PRIOR TO THE PREPARATION OF CONSTRUCTION DRAWINGS. THE PLAN IS SUITABLE FOR DESIGN ONLY & MAY NOT BE SUITABLE FOR ANY OTHER PURPOSE OR FOR USE AT ANY OTHER SCALES/S.
2. THE BOUNDARIES & SERVICES SHOWN ARE APPROXIMATE ONLY. FURTHER SURVEY WILL BE REQUIRED IF CONSTRUCTION IS TO TAKE PLACE ON OR ADJACENT TO THE BOUNDARIES.

**NOTE** • ANTICIPATED LOT CLASSIFICATION IS H2

**DELFS LASCELLES**  
CONSULTING SURVEYORS

**THE FAIRWAYS**  
SINGLETON

# LOT 315

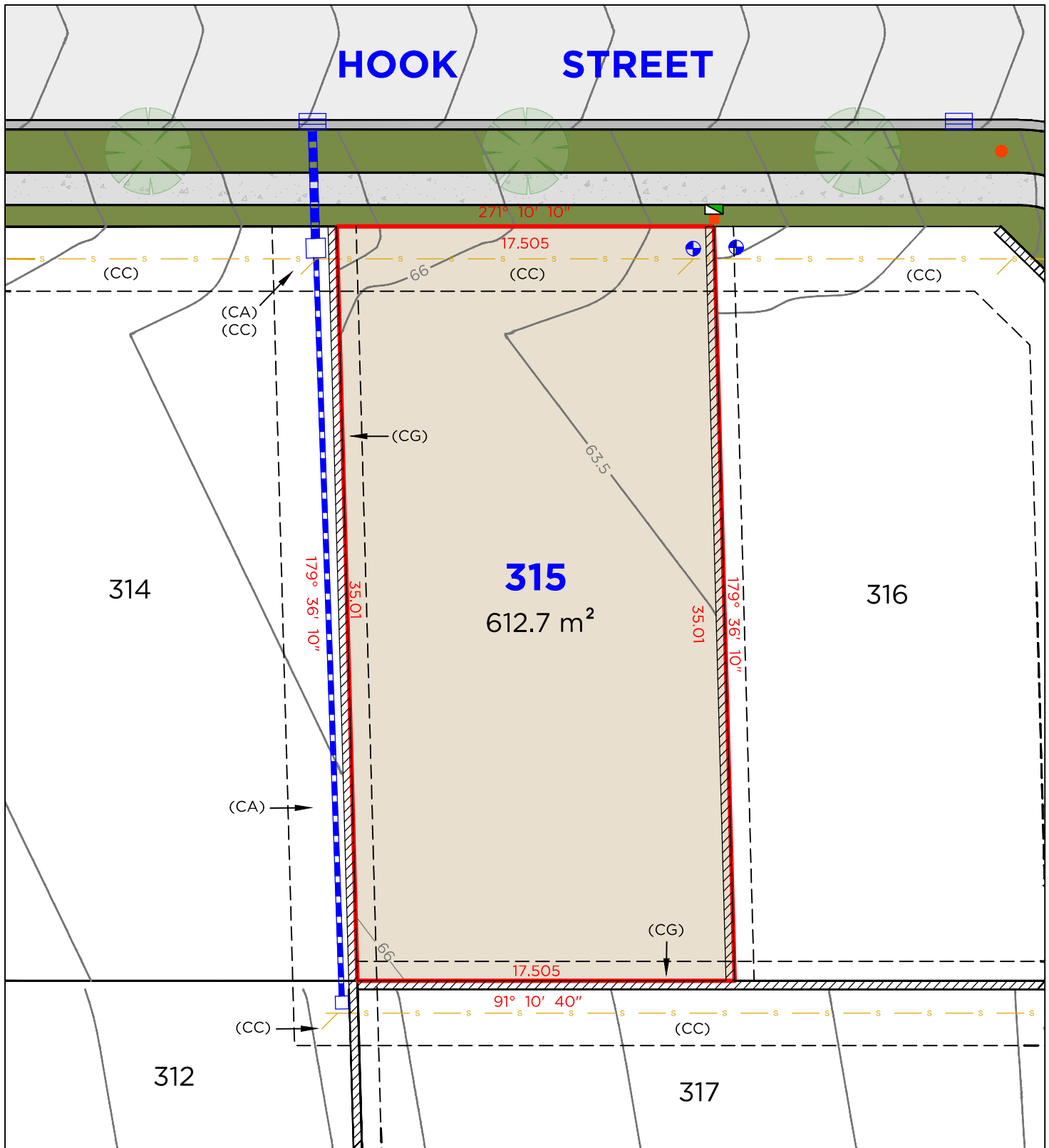

## LEGEND

- |  |                   |  |                   |
|--|-------------------|--|-------------------|
|  | BOUNDARY LINE     |  | TELSTRA / NBN PIT |
|  | ADJACENT BOUNDARY |  | ELECTRICAL PILLAR |
|  | EASEMENT          |  | LIGHT POLE        |
|  | SEWER             |  | SEWER MAN HOLE    |
|  | STORMWATER        |  | DRAINAGE PIT      |
|  | RETAINING WALL    |  | KERB INLET PIT    |
|  | WATER METER       |  | STOP VALVE        |
|  | HYDRANT           |  |                   |

## EASEMENTS

- (CA) EASEMENT TO DRAIN WATER 3 WIDE
- (CC) EASEMENT TO DRAIN SEWAGE 3 WIDE
- (CG) EASEMENT FOR SUPPOT 0.9 WIDE

## DISCLAIMER

1. THIS PLAN HAS BEEN COMPILED FROM DESIGN PLANS AT THE SCALE/S STATED. IT IS RECOMMENDED THAT A SURVEY IS UNDERTAKEN PRIOR TO THE PREPARATION OF CONSTRUCTION DRAWINGS. THE PLAN IS SUITABLE FOR DESIGN ONLY & MAY NOT BE SUITABLE FOR ANY OTHER PURPOSE OR FOR USE AT ANY OTHER SCALES/S.
2. THE BOUNDARIES & SERVICES SHOWN ARE APPROXIMATE ONLY. FURTHER SURVEY WILL BE REQUIRED IF CONSTRUCTION IS TO TAKE PLACE ON OR ADJACENT TO THE BOUNDARIES.

**NOTE** • ANTICIPATED LOT CLASSIFICATION IS H2

**DELFS LASCELLES**  
CONSULTING SURVEYORS

THE FAIRWAYS  
SINGLETON